

# Neco Euro vision-wifi

## User Manual



### Set APP :

Android devices search for "Tuya Smart" or "Smart Life" in App Store to download in Mobile Assistant, iPhone and iPad. Or scan the QR code to download.



Tuya Smart



Smart Life

## **Register/Login Existing Account:**

### **1. Register a new account**

If you don't have an App account yet, you can register an account or log in via SMS verification code. Please read the current page and the next page for instructions on the registration process.

Click "Register Account" to enter the Tuya Smart App Privacy Policy page, click Agree, and enter the mobile phone number or email registration page.

### **2. Log in with your existing account**

If you have already registered an account, you can skip creating a new account and click "Log in with an existing account" to enter the login page.

(1) The system automatically selects the current country/region, or you can manually select the country/region.

(2) Enter your registered mobile phone number or email address, and enter your password to log in the system.

(3) Sign in using your social media account Sign in using the social media account area.

## **Log in the account:**

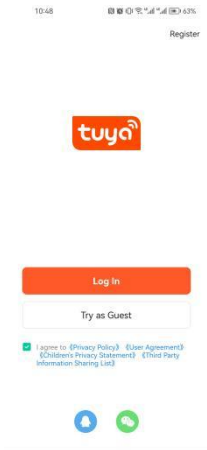

## To add a device:

### Method①: QR code pairing

1. Connect your WIFI and BLUETOOTH on phone. This product supports only 2.4GHz Wi-Fi, not 5GHz Wi-Fi. Before configuring Wi-Fi, set the router parameters. When configuring Wi-Fi, make sure your router, phone, and device are as close as possible for quick device configuration.
2. Power on the camera and wait when you hear "the device is ready to config, please scan the QR ". (If you don't hear anything, click "reset" to restore the factory settings.).
3.
  - ① click "Add Device" on the App homepage, select "Camera/Lock",
  - ② "Smart Camera (WiFi)", and click "Next".
  - ③ Enter the Wi-Fi account and password and click "Next".
  - ④ Hold the phone screen in front of the lens (plus the picture), and the distance between them should be 15 to 20 centimeters. (Plus picture) Try not to shake the phone.

- ⑤ When you hear "Network config completed, connecting.", click "I Heard a Prompt", and then wait for the connection (with a picture). If connect failure, you will here" wifi config failed, please check user name and password'
- ⑥ When the camera home page shows Added successfully, then click" Done"

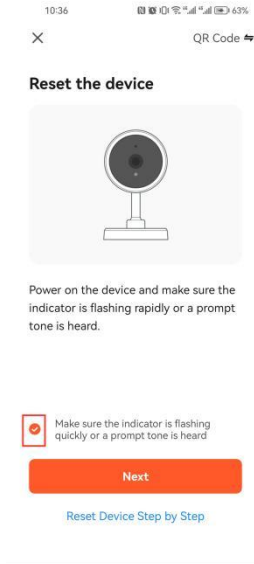

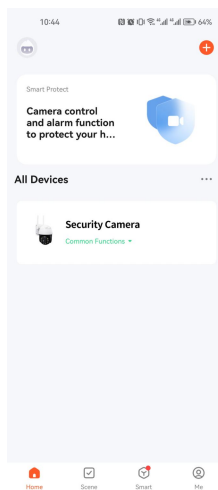
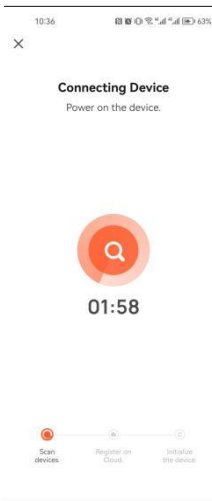

#### 4.Hand set copy (as shown):

1.press copy on phone ,then press open or close or stop that you need ,then Camera flash slowly to into copy,then press hand set button(for example ,if you press open on phone ,then you need press open button on hand set) near the camera,after copy success,camera Flash fast.To copy more buttons,do the same.

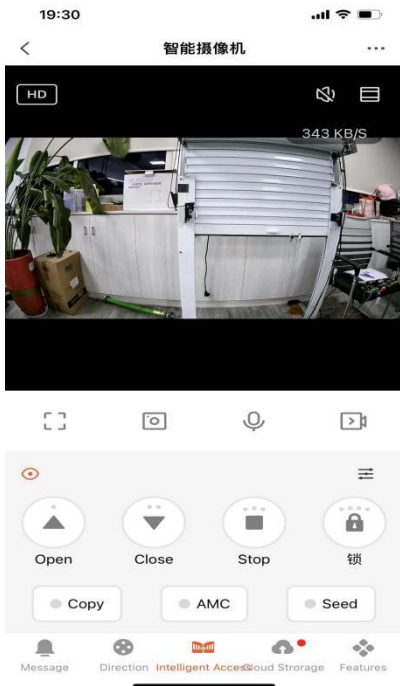

#### Configuration list:

Camera -- 1; Instructions -- 1;

Power adapter (DC12V1.5A) -- 1

