

THIS DRAWING MUST BE READ IN CONJUNCTION WITH OTHER ARCHITECT'S, CONSULTANT'S, SUB-CONTRACTOR'S AND SPECIALIST DRAWINGS.

ALL DIMENSIONS ARE IN MILLIMETRES UNLESS STATED OTHERWISE.

ALL DIMENSIONS ARE TO BE VERIFIED ON SITE AND CONFIRMED, BY THE CONTRACTOR, BEFORE COMMENCEMENT OF CONSTRUCTION.

IF THIS DRAWING EXCEEDS THE QUANTITIES TAKEN, IN ANY WAY, THE ARCHITECTS ARE TO BE INFORMED BEFORE THE WORK IS PUT IN HAND.

Rev	Date	Revision	By	Chk
-	-	-	-	-

Notes

Le Page Architects

Le Page Architects Limited
Plumer House
Tailyour Road
Crownhill
Plymouth
PL6 5DH
Tel: +44 (0)1752 849 880

Email: enquiries@lepagearchitects.com
Web: http://www.lepagearchitects.com

Client
PCC of St Thomas, Exeter

Project Name
St Thomas Church Reordering

Drawing
Ground Floor Plan
Proposed Option 05a
Scale 1:100 @ A3

Drawn by
AB
Checked by
CS
Date
10/04/24
11/04/24

Project No. Drawing No Revision

J23.064 SK05.01 -

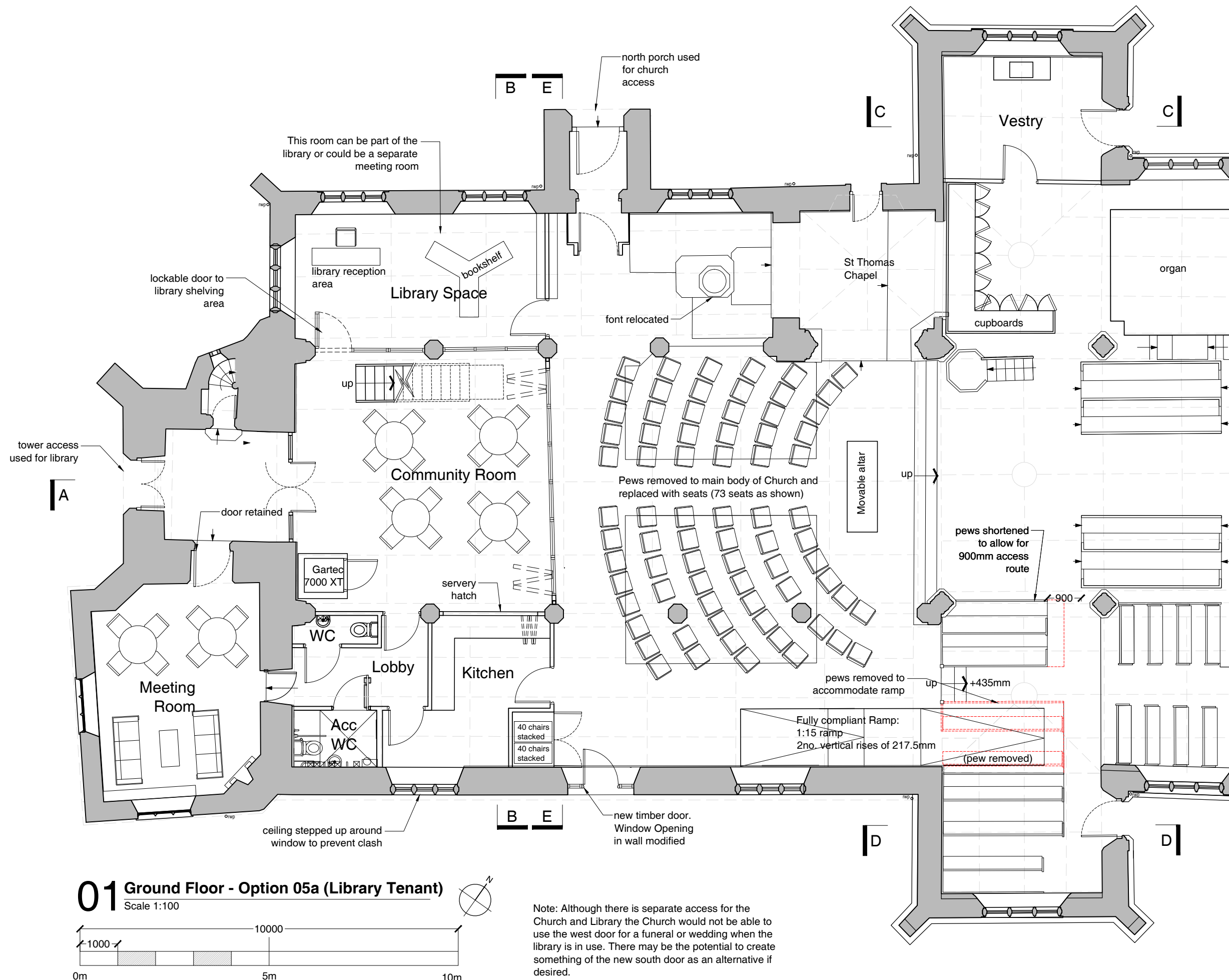

01 Ground Floor - Option 05a (Library Tenant)

Scale 1:100

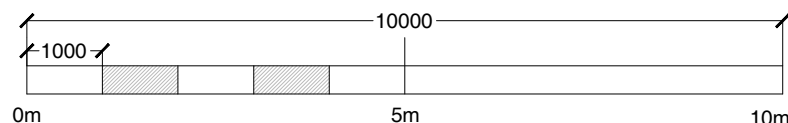

Note: Although there is separate access for the Church and Library the Church would not be able to use the west door for a funeral or wedding when the library is in use. There may be the potential to create something of the new south door as an alternative if desired.